

DETACHED GARAGE

City of Portsmouth, NH - 1 Junkins Ave, (603) 431-2006 x243

www.cityofportsmouth.com

Received

Building Permit Application - RESIDENTIAL ADDITIONS

Office Use: Cost of All Construction: \$ _____ Fee: \$ _____ Chk #: _____ Cash: _____
 Zoning District: _____ HD-A: _____ Map #: _____ Lot #: _____ Index #: _____ Building Permit #: _____

Print in Ink or Type. Complete all blanks or indicate "N/A" if not applicable.

PROPERTY OWNER

Name: GAIL SOMERS
 Address: 34 NO. WEST ST
St. Number Street Name
 City: PORTSMOUTH State: NH Zip: 03801
 Phone: (603) 431-2181 Fax: () N/A
 Cell Phone / Pager: 603 949-2357

PERMIT APPLICANT

Name: OWNER
 Address: _____
St. Number Street Name
 City: _____ State: _____ Zip: _____
 Phone: () _____ Fax: () _____
 Cell Phone / Pager: () _____

Address of Construction: 34 NORTH WEST ST Unit #: _____
Street Number Street Name
 Brief Description of Proposed Work: DETACHED GARAGE
 Contractor: OUT-TO-BID Phone: () _____ Cell/Pager: () _____
 Contractor Address: _____

Existing Conditions (Land Use Data)

Lot Area: 19,880 S.F.; Existing Use of Land and Building(s): 2 FAMILY HOME
 # of Existing Dwellings: 2; # of Existing Off Street Parking Spaces Provided on the Lot: 3
(Not applicable to single family uses.)

Dimensions of Existing Building(s) & Structure(s) on this Lot

	Size *	S.F. of Footprint	#. of Stories	Ht. of Struct.	Basement (Y/N)
Main Building:	<u>55 x 42</u>	<u>2310</u>	<u>2</u>	<u>28'</u>	<u>Y</u>
Attached Garage:	___ x ___	___	___	___	___
Addition #1:	___ x ___	___	___	___	___
Addition #2:	___ x ___	___	___	___	___
Porch:	___ x ___	___	___	___	___
Deck:	<u>22 x 11</u>	<u>242</u>	<u>1</u>	<u>4'</u>	<u>N</u>
Detached Garage:	___ x ___	___	___	___	___
Shed:	___ x ___	___	___	___	___
Other:	___ x ___	___	___	___	___
Other:	___ x ___	___	___	___	___
Other:	___ x ___	___	___	___	___
TOTAL SQUARE FOOTAGE:		SUM = <u>2552 SF</u>			

* If structures are irregular in size, write "irregular" and fill the foundation square foot area under "SF of footprint".

Existing Building Setback Dimensions (Indicate the least setback dimension for each.)

To House
 Front Setback: 30 Ft.; Rear Setback: 40 Ft.; Left Side Setback: 19' Ft.; Right Side Setback: _____ Ft.
 Closest to nearest Wetlands (If applicable): NA Ft. Inland Wetland Coastal Wetland

All above information shall be shown on a site plan submitted with this application.

Proposed Conditions (Land Use Data)

of Newly Created Dwelling Units 0 ; S.F. of ea. New Unit(s) _____ ; _____ ; _____ ; _____ ; _____
(Net Living Area, per New Unit)

Sum of all New Unit's S.F. 0 ; Number of New Off Street Parking Spaces Provided on the Lot 2 (IN GARAGE)
(Sum of the Individual Units Listed Above) (Not applicable to single family uses.)

Dimensions of New Additions on this Lot

	Size *	S.F.. of Footprint	#. of Stories	Ht. of Struct.	Basement (Y/N)
Addition #1:	_____ x _____	_____	_____	_____	_____
Addition #2:	_____ x _____	_____	_____	_____	_____
Addition #3:	_____ x _____	_____	_____	_____	_____
Attached Garage:	_____ x _____	_____	_____	_____	_____
Porch:	_____ x _____	_____	_____	_____	_____
Deck:	_____ x _____	_____	_____	_____	_____
Detached Garage:	<u>22</u> x <u>20</u>	<u>440</u>	<u>1</u>	<u>14</u>	<u>N</u>
Shed:	_____ x _____	_____	_____	_____	_____
Other:	_____ x _____	_____	_____	_____	_____
Other:	_____ x _____	_____	_____	_____	_____
Other:	_____ x _____	_____	_____	_____	_____
Other:	_____ x _____	_____	_____	_____	_____
TOTAL SQUARE FOOTAGE:		SUM = <u>440</u>			

* If structures are irregular in size, write "irregular" and fill the foundation square foot area under "SF of footprint".

Proposed Building Setback Dimensions (Indicate the least setback dimension for each.)

Front Setback: 98 Ft. ; Rear Setback: 14 Ft. ; Left Side Setback: 92 Ft. ; Right Side Setback: 21 Ft.
 Closest Dimension to Nearest Wetlands (If applicable): NA Ft. Inland Wetland Coastal Wetland

All above information shall be shown on a site plan submitted with this application.

Construction Information

Every addition is different in terms of layout and framing details. Therefore, it is imperative that a set of construction plans or sketches be submitted with this application. The plans/sketches must show a dimensioned layout of all new rooms and spaces, in enough detail to determine building code compliance with the proposed construction. In a few cases, it may be necessary to show the existing room layout. The following is a list of specific items to be included with the plans/sketches and specifications:

Some of this information may not be needed, depending on the type of addition/construction being proposed.

- Foundation plan including anchor bolt/strap information.
- Floor plan of each story. (Show attic access location.)
- Framing plan of each story including sizes & spacing of joists and beams.
- Roof framing plan including sizes & spacing of rafters and roofing materials.
- If cathedral ceiling design, provide supported ridge details.
- Framing cross sections where applicable.
- Wall sections, showing all wall materials, including header sizes.
- Bedroom window sizes and if "tilt-clean" style.
- Insulation amounts on all exterior walls and ceilings (Including basement).
- All interior and exterior stair details showing tread depth, riser height, and guard protection.
- Stair handrail and deck guardrail details.
- Location of hard wired smoke detectors.

Construction Information-Continued

GARAGE

Indicate information on the various additional trades or features listed below:

Sewerage System: City Sewer? Y (N) Subsurface? Y (N) State Septic Permit Number _____
City Water? Y (N) State Well Permit Number: _____
Plumbing Contractor: (Separate Permit Required) NA
Mechanical Contractor: (Separate Permit Required) NA
Electrical Contractor: (Separate Permit Required) NOT SELECTED
Fire Sprinkler System?: Y (N) (Separate Permit Required) Contractor _____

Expanded description of work :

NEW 2 CAR GARAGE (DETACHED)

SEE ATTACHED SKETCHES

National Flood Insurance Program Data: Flood Insurance Rate Map (FIRM) Community Number: 330139
Map Panel Number: _____ FIRM Zone *: _____ Base Flood Elevation (BFE): 9 feet (NGVD)
Elevation of lowest floor (including basement): _____ feet (NGVD) Elevation Certificate Submitted (Y/N): _____

- * If addition is NOT located in a Special Flood Hazard Area (SFHA) check here:
- * If addition IS located in a SFHA based on the FIRM, but a land survey shows the property is either outside the floodplain or the actual elevation of the lowest floor level is above the BFE, then a Letter of Map Amendment (LOMA) should be completed by the owner and/or design professional.

NOTE: If the building addition is within the SFHA an *Elevation Certificate* is required to be completed by a licensed design professional.

✓ Plans Submitted: Site Floor _____ Framing Electrical _____ Plumbing _____ Mechanical _____ Rolled _____
Other _____

Cost of All Construction / Renovation: \$ 10,000 (ESTIMATE)

I certify that the information given is true and correct to the best of my knowledge. *No change from the above information will be made without approval of the Building Inspector.* Construction activities shall not commence until the Building Permit is issued.

I realize that when all necessary approvals have been acquired, a Building Permit may be granted by the Building Inspector to allow construction in conformance with this application and the plans/specifications submitted in support of said construction only.

I further acknowledge that the proposed structure shall not be occupied or otherwise utilized without the issuance of a Building Certificate of Occupancy and only after all necessary inspections have been requested and completed. I am also aware that the disposal of waste generated from this project is my responsibility and not part of the City's curbside collection program.

Carl Sommer
Signature of Applicant

7/31/03
Date

OWNER
If Not Owner, State Relationship

BY _____ DATE _____

SUBJECT _____

SHEET NO. 1 OF 5

CHKD. BY _____ DATE _____

JOB NO. _____

SAMPLE NEW CONSTRUCTION : TWO CAR GARAGE

EXTENT OF WORK

1. REMOVE SOD & TOPSOIL, EXCAVATE ADDITIONAL 12".
2. INSTALL, LEVEL, AND COMPACT 12" CLEAN GRAVEL.
3. EXCAVATE TRENCH AT BLDG PERIMETER TO BELOW FROSTLINE.
4. POUR 12" x 12" FOOTING, 8" THICK FOUNDATION WALL (WITH ANCHOR BOLTS) AND 4" SLAB (WITH WIRE MESH)
5. ERECT GARAGE AS PER PLANS.
6. LAY ADDITIONAL ASPHALT TO JOIN GARAGE AND EXISTING DRIVEWAY.

BY _____ DATE _____

SUBJECT _____

SHEET NO. 2 OF 5

CHKD. BY _____ DATE _____

JOB NO. _____

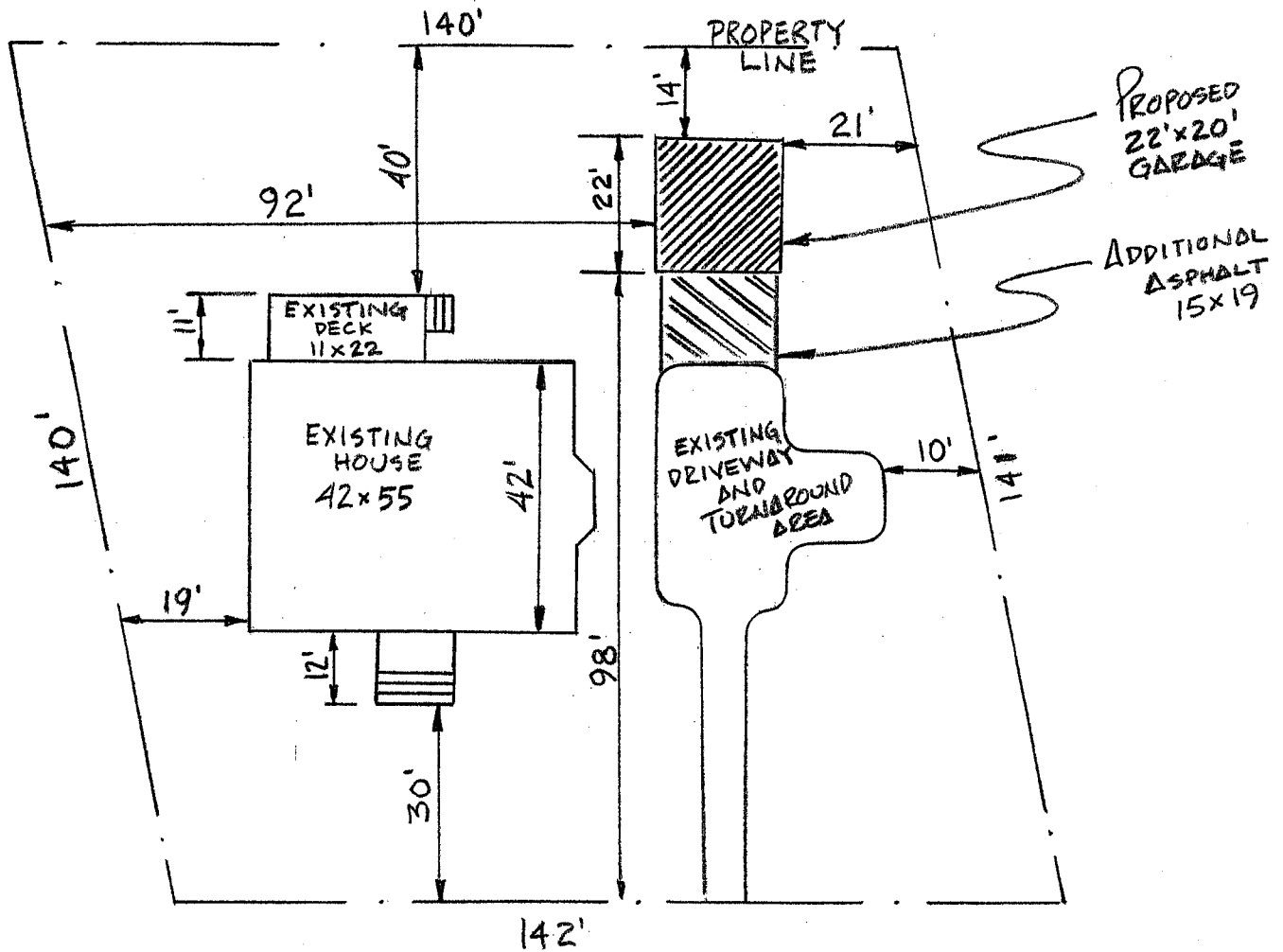

SITE PLAN SAMPLE

34 NORTH WEST ST.

BY _____ DATE _____

SUBJECT _____

SHEET NO. 3 OF 5

CHKD. BY _____ DATE _____

JOB NO. _____

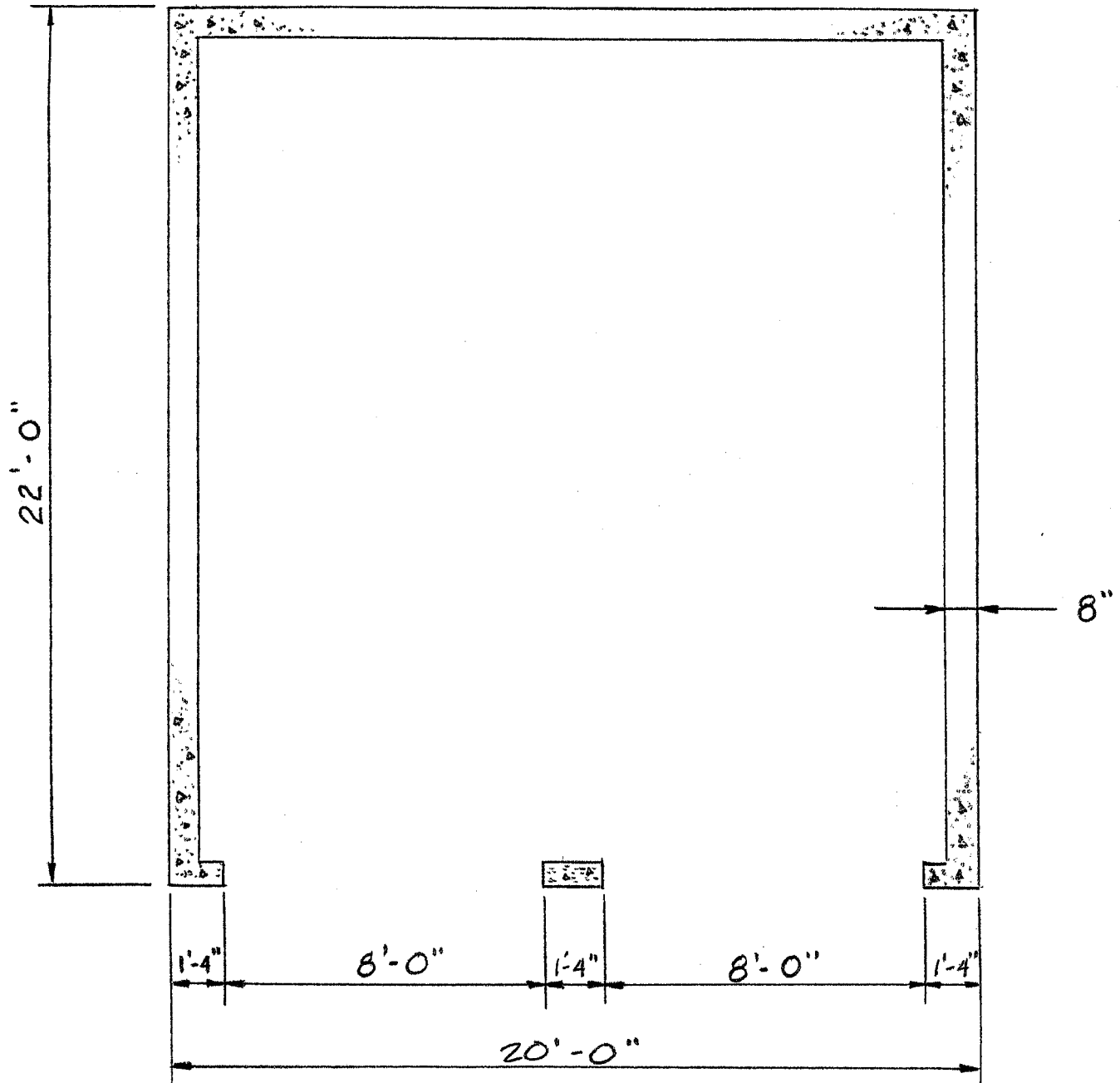

FOUNDATION PLAN SAMPLE

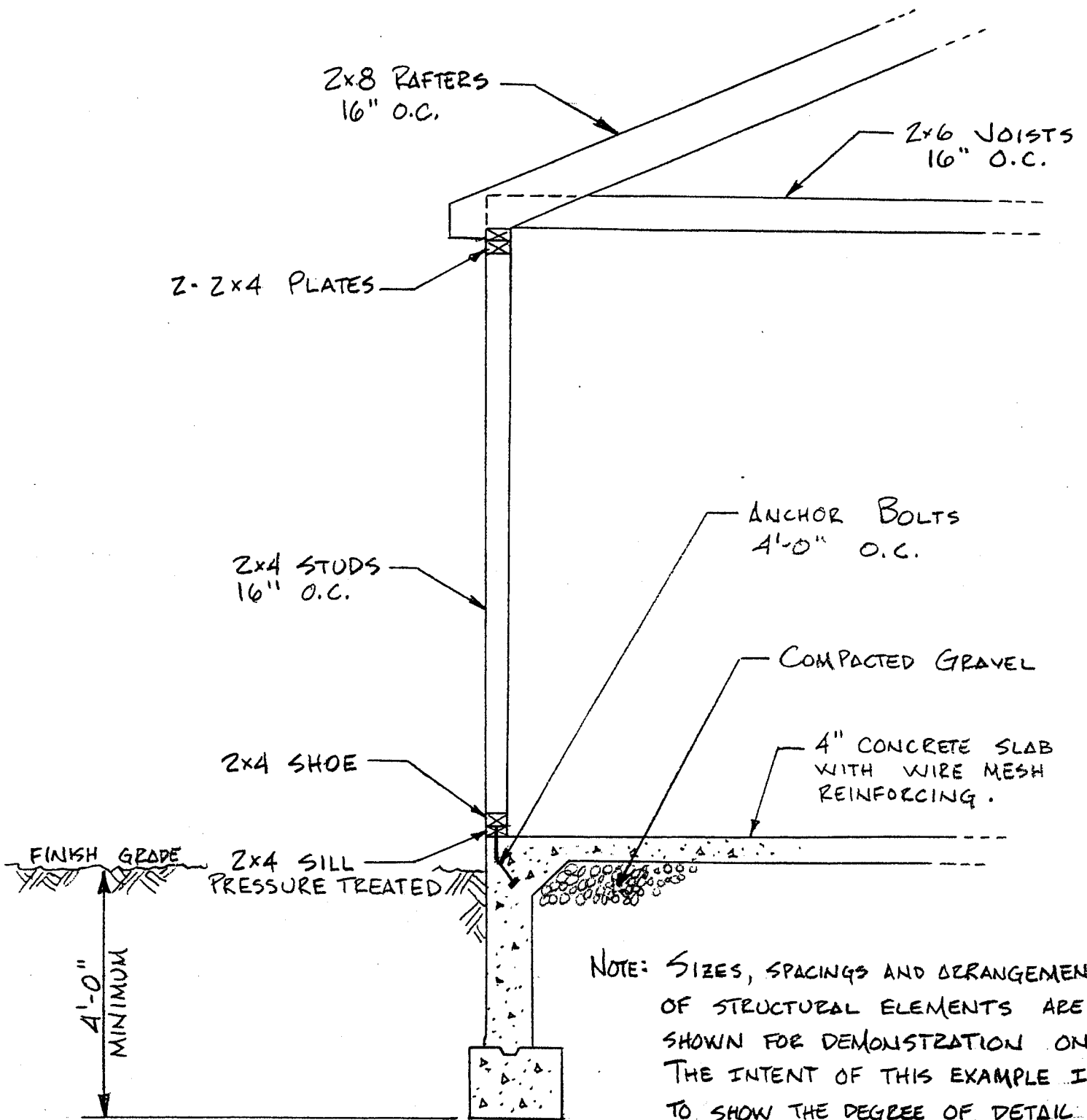

TYPICAL WALL SECTION SAMPLE

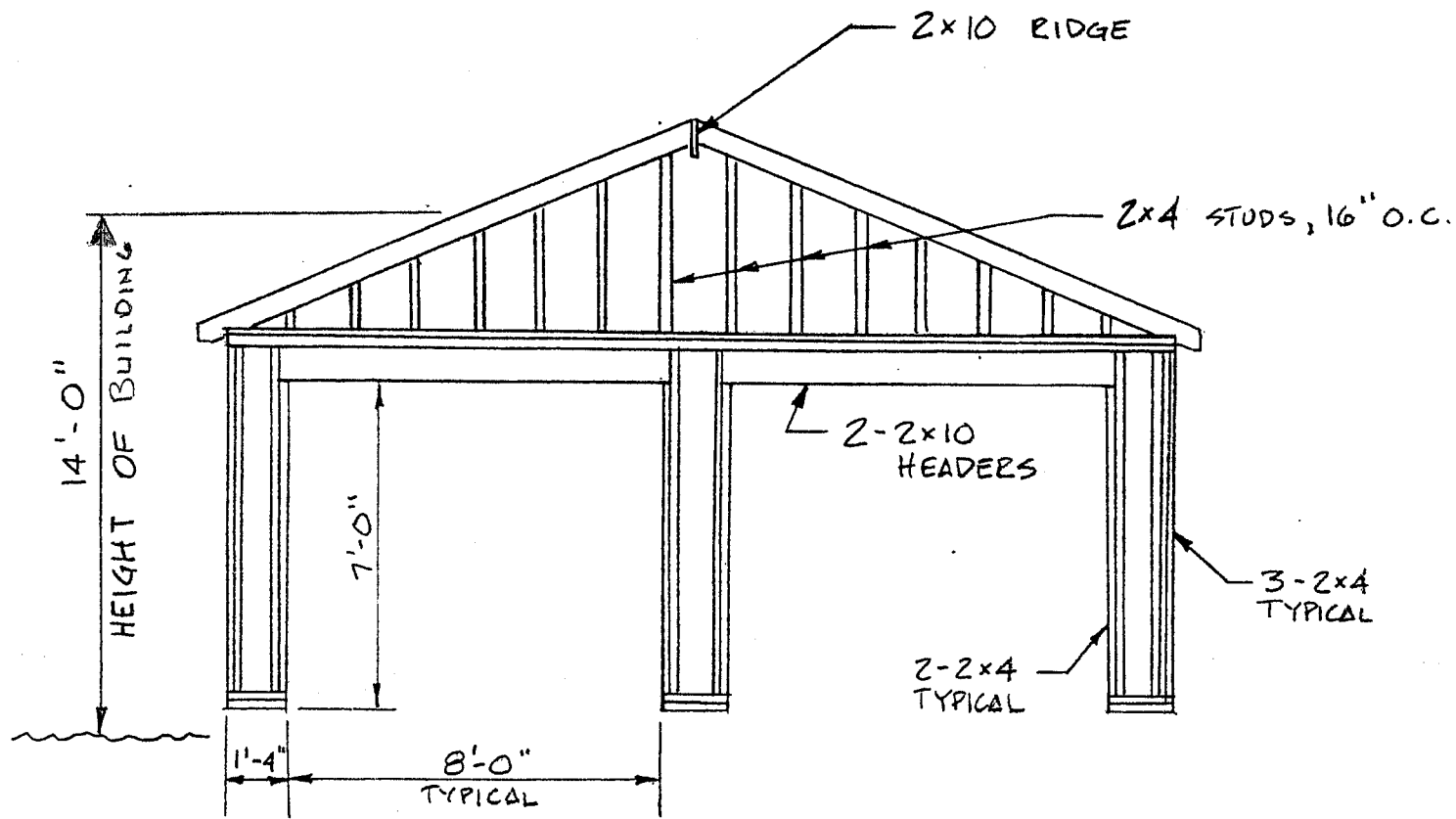

FRAMING @ OVERHEAD DOORS -- SAMPLE

NOTE: STRUCTURAL MEMBER SIZES, SPACINGS AND ARRANGEMENT ARE SHOWN FOR DEMONSTRATION PURPOSES ONLY. ACTUAL MEMBER SIZING, SPACING AND ARRANGEMENTS FOR ANY STRUCTURE DEPEND UPON SEVERAL VARIABLES UNIQUE TO EACH INDIVIDUAL CASE. THE INTENT OF THIS EXAMPLE IS TO SHOW THE DEGREE OF DETAIL THAT SHOULD BE INCLUDED WITH A PERMIT APPLICATION.