

LEGEND

- EXISTING CATCH BASIN
- BOLLARDS
- UTILITY POLE
- HYDRANT
- GATE VALVE
- NEW LIGHT POLE
- CATCH BASIN
- R=15' PROPOSED RADIUS
- EP EDGE OF PAVEMENT
- 13 EXISTING CONTOUR
- +15.3 EXISTING SPOT GRADE
- NEW SIDEWALK AREAS
- PB NEW PULL BOX
- AP ANGLE POINT

PARKING SPACES:

EXISTING	PROPOSED
19 2 HOUR	18 2 HOUR
2 15 MINUTE	1 15 MINUTE
1 HANDICAPPED	1 POLICE
1 POLICE	1 TAXI
1 TAXI	2 LOADING

NOTES:

- UTILITIES (IF SHOWN) ARE APPROXIMATE, CALL 1-800-DIG-SAFE PRIOR TO ANY EXCAVATION.
- ALL MATERIALS PROPOSED ON THIS PLAN ARE TO MEET NHDOT, NEC & CITY STANDARD SPECIFICATIONS.
- TOPOGRAPHY IS BASED NVD 83.
- PARKING SPACES WILL BE AVAILABLE FOR PUBLIC USE AT NIGHT IF IT IS SAFE AND REASONABLE.
- ALL NEW SIDEWALKS MUST BE COMPLETE WITHIN 3 WEEKS OF OLD WALK REMOVAL.
- HOURS OF WORK WILL BE 7 AM TO 5 PM DAILY. WEEKEND WORK WILL NOT BE ALLOWED.
- THE STREET WILL NOT BE SHUT DOWN TO TRAFFIC.
- PORTSMOUTH POLICE WILL NEED TO BE HIRED FOR THE DURATION OF THE PROJECT WHENEVER CONSTRUCTION OR VEHICLES ARE IN THE ROAD.
- ALL BUSINESSES AND RESIDENCES MUST HAVE SAFE ACCESS AT ALL TIMES.
- CONTACT PSNH FOR OLD LIGHT POLE REMOVAL.
- THE CITY OF PORTSMOUTH HAS BOUGHT THE LIGHTS FOR THE PROJECT AHEAD OF TIME. THE CONTRACTOR WILL BE RESPONSIBLE FOR MOVING THE LIGHTS TO THE SITE, CLEANING THE LIGHTS, INSTALLING THE LIGHTS, PAINT TOUCH UPS, WIRING THE LIGHTS, INSTALLING THE BASES, UPGRADING THE ELECTRICAL PANEL, PROVIDING THE CONTACTOR AND PHOTOCELL, AND ANY OTHER ASSOCIATED BUT UNLISTED TASK.
- ALL SIDEWALKS MUST BE SAFE FOR THE GENERAL PUBLIC AT ALL TIMES. BARRICADES, SIGNS ETC. WILL BE PROVIDED UNDER THE MAINTENANCE OF TRAFFIC ITEM IF NEEDED TO PROTECT THE PUBLIC. IT IS THE DECISION OF THE ENGINEER WHETHER THE CONTRACTOR HAS SUPPLIED THE PROPER SAFETY SUPPLIES. THE CONTRACTOR MAY BE REQUIRED TO PROVIDE TEMPORARY SIDEWALKS AND "BRIDGES" INTO BUSINESS OPENINGS AS NEEDED AND AS DETERMINED BY THE CITY.
- THE CONTRACTOR WILL SUPPLY THE CITY WITH A 24 HOUR PHONE NUMBER IN CASE OF EMERGENCY.
- CALCIUM OR OTHER DUST CONTROL MEASURES WILL BE PROVIDED IF DEEMED NECESSARY BY THE ENGINEER.
- COORDINATE WITH THE CITY FOR PARKING METER REMOVAL AND REPLACEMENT.
- DRAINAGE LINES THAT CROSS WITHIN 12" OF A SEWER OR WATER LINE SHALL BE INSULATED WITH POLYSTYRENE.

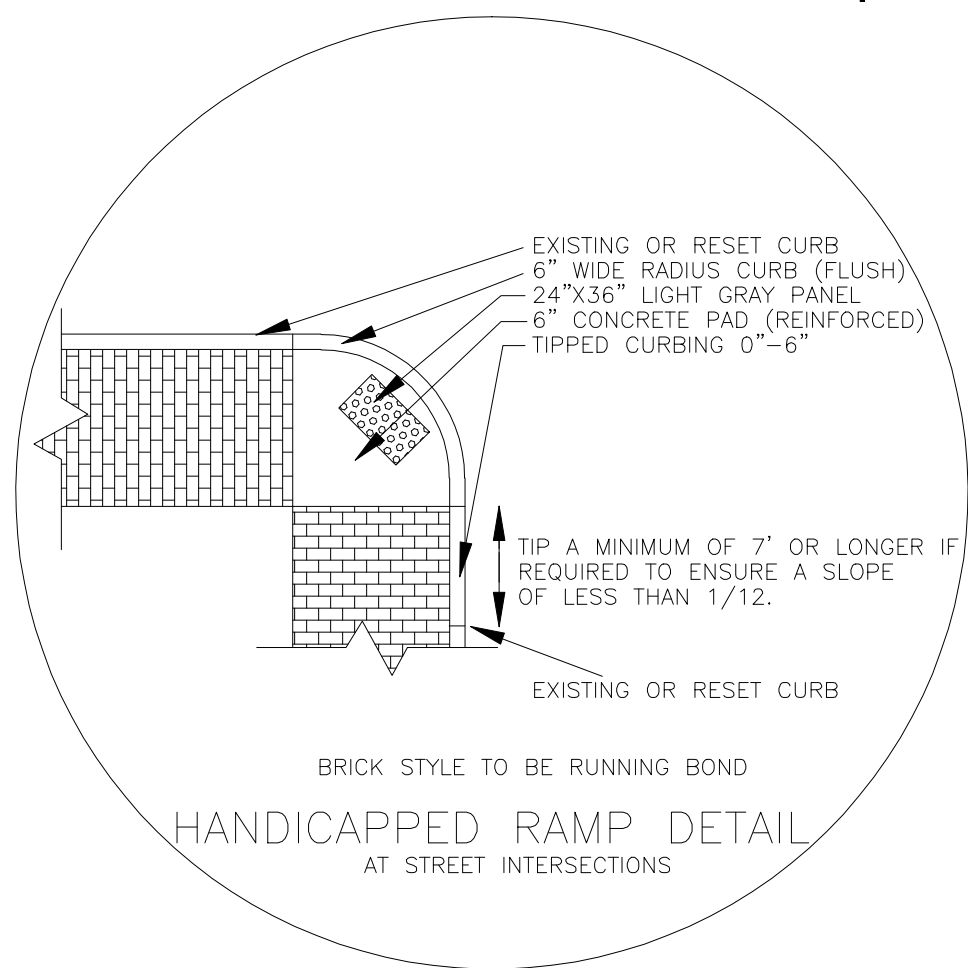
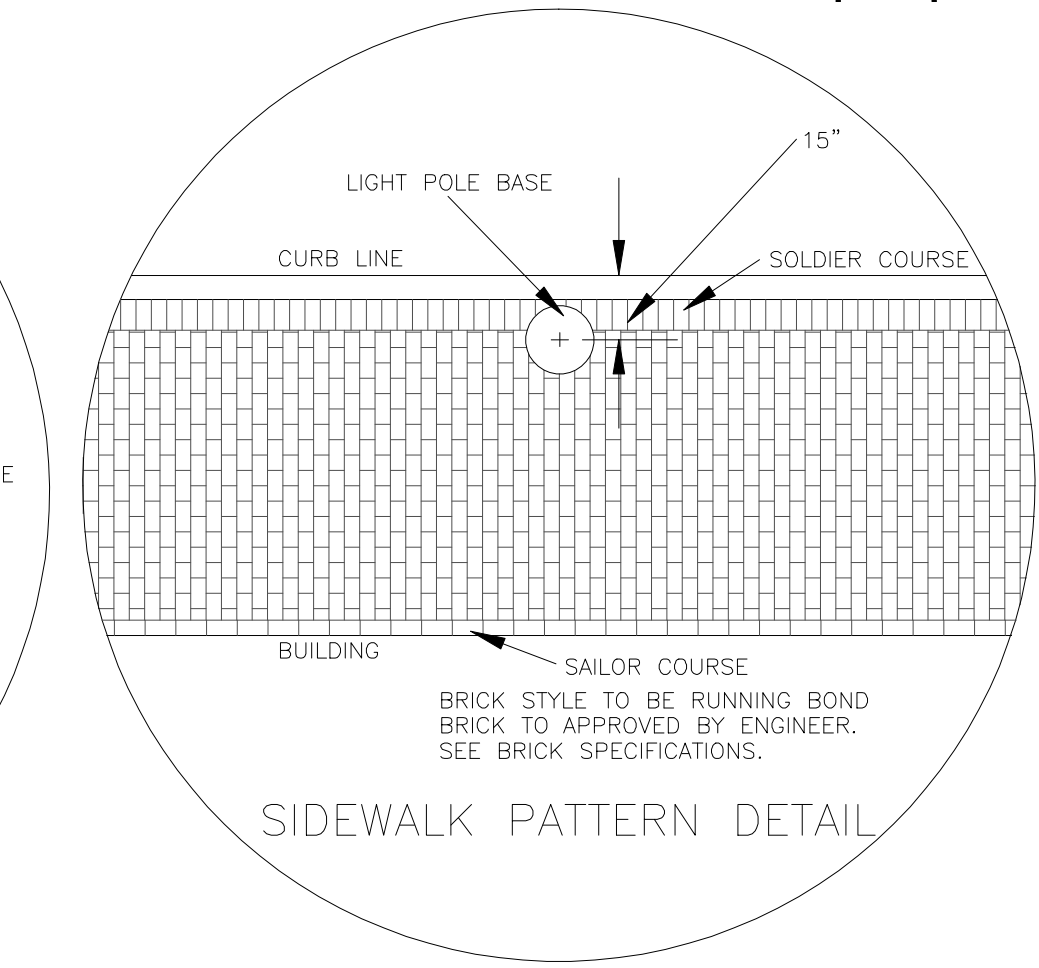
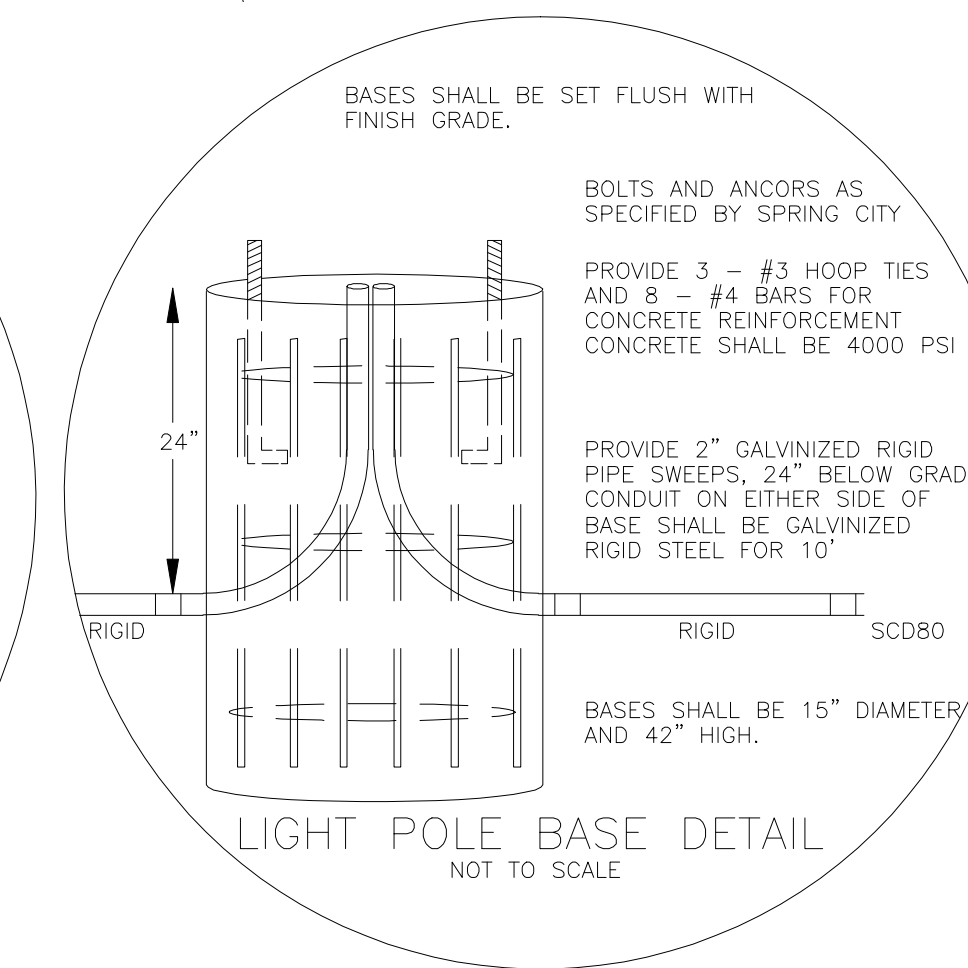
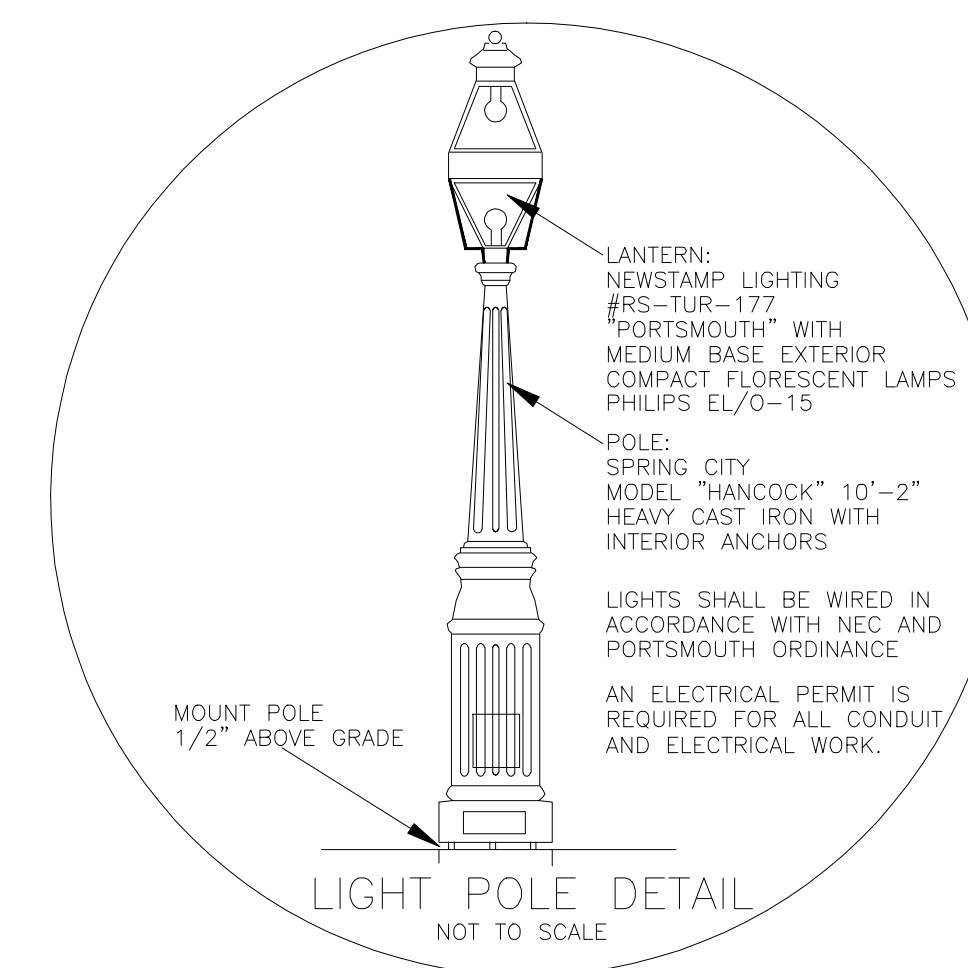
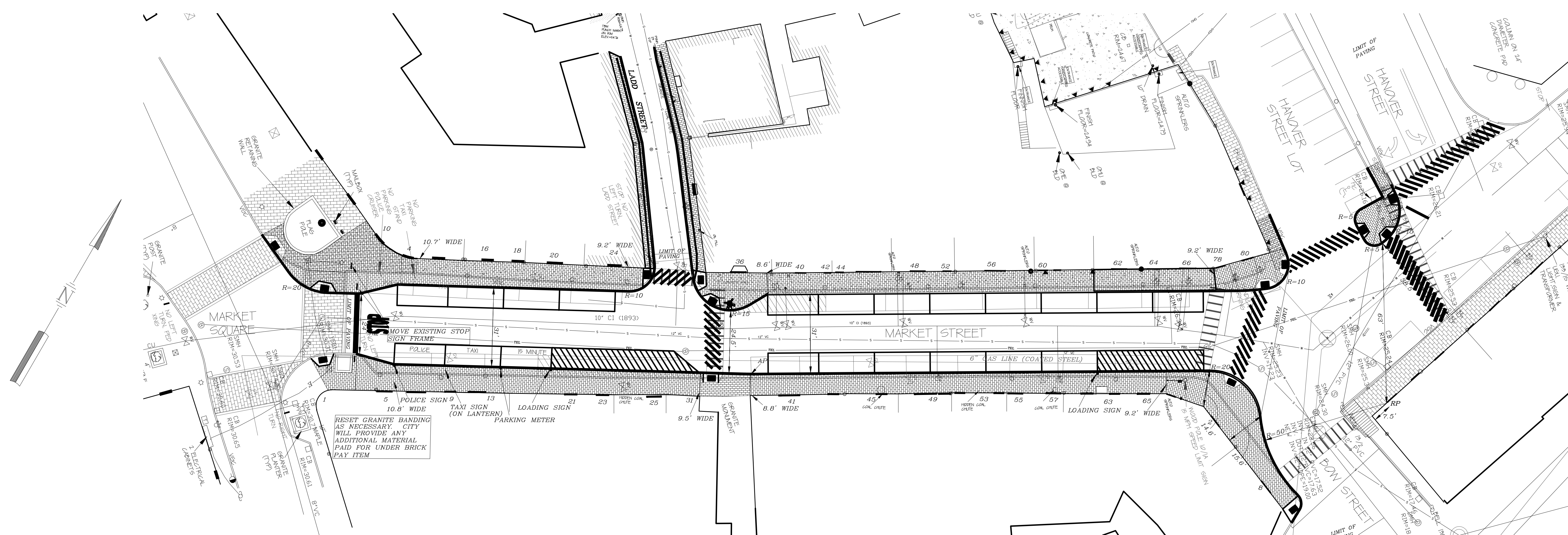

MARKET STREET SIDEWALK REPLACEMENT LAYOUT PLAN
 DEPARTMENT OF PUBLIC WORKS
 CITY OF PORTSMOUTH
 NEW HAMPSHIRE

SCALE: 1"=20' <MARKETSTPLAN> MARCH 2008

SHEET 1 OF 2